

# 435 *GTO*



## propulsion

### TRIPLE MERCURY VERADOS

	cruising speed*	maximum speed*
Triple-600 HP	40 MPH	55 MPH

length overall	44' 9" / 13.65 M
hull length	41' 2" / 12.55 M
beam (normal)	13' 6" / 4.15 M
beam (balconies down)	19' 5" / 5.91 M
dry weight	35,314 LB / 16,018 KG (est)
maximum load weight	43,431 LB / 19,700 KG (est)
draft max.	3' 9" / 1.18 M
transport height	14' / 4.29 M
fuel capacity (gas)	528 GAL / 2000 L
water capacity	79 GAL / 300 L
black water capacity	26 GAL / 100 L
grey water capacity	39 GAL / 150 L

The specification measurements are approximate and subject to variance.

\*The listed performance data is an estimate only based on vessel testing on fresh water with 6 people, full fuel and water and a clean hull bottom. The performance will change based on boating location, vessel loading and maintenance.

**GALEON**  
YACHTS  
galeonyachts.us

# GTO

**T**he Galeon 435 GTO is the next-in-line of powerful, outboard models with its sleek contours and versatile space distribution on board, bound to stand out in any marina. The silhouette is a clear evolution of the acclaimed 375 GTO with even more aggressive lines and eye-catching details fitted onto the two-tone exterior. The striking side profile features full-length hull windows and partially glazed balconies, while the wheelhouse has unobstructed, 360° views.



*Have more space to stretch out and enjoy hovering above the water in Beach Mode.*



*Immerse yourself in a sleek and modern helm inspired by high-performance sports cars with a luxurious feel.*



*The forward cabin feels like that of a much larger Galeon yacht, plenty of natural light with best in class head.*

Note: Layout and features may vary from shown here due to manufacturer consideration and client customization.

# 435 GTO

## STANDARD FEATURES

### EXTERIOR

#### *Exterior Upholstery*

- Silver & Grey

#### *Hull & Deck Accessories*

- Cleats, stainless steel
- Flooring, molded non-skid
- Horn, electric
- Lights, navigation
- Mooring system
  - Reversible electric anchor winch
  - Anchor roller
  - Galvanized anchor and chain
  - Fiberglass deck hatch to self-draining chain locker
- Radar mast, stainless steel
- Rubrail, PVC with stainless steel insert
- Searchlight, remote-controlled
- Thru-hull fittings, stainless steel/bronze
- Windshield, tempered glass

#### *Cockpit*

- Air conditioning vents at helm
- Cupholders
- Door, cabin entrance – sliding and lockable, plexiglass
- Door, salon entrance – lockable, aluminum
- Handrails, 316 stainless steel
- Hardtop, fiberglass
- Defrosters for windshield
- Helm Station
- Console rail, stainless steel
- Compass
- Helm, 3 seats with bolster and adjustment
- Station instruments and controls
  - Digital gauges
  - Switches
  - Alarm, High Water – bilge
  - Start keys, 3 position
  - Dual Lever Control, EVC
  - Joystick Piloting with SkyHook and Auto Pilot
  - Trim tab control panel
  - Outlet, USB

- Steering wheel, adjustable
- Stereo remote control
- Windscreen wiper with front window washing system
- Lighting, indirect LED
- Lighting, direct LED
- Outlet, 120V GFI
- Seating with table (fiberglass)
- Speakers
- Storage, side lockers
- Shower wand, aft cockpit, hot and cold
- Wet bar with sink, electric grill, and trash bin
- Refrigerator

#### *Galley*

- Ambient LED lights
- Corian countertops
- Sink, chrome faucet and Corian cover
- Light, overhead LED
- Microwave, 120V
- Outlet, 120V GFI protected
- Refrigerator, 120V with freezer compartment
- Storage, cabinets with overhead cupboard

#### *Stern*

- Cleats, stainless steel
- Doors
- Lighting, indirect LED
- Shore power inlet, dual 120V/30A
- Shore water connection

### INTERIOR

#### *Interior Color & Materials*

- Cabinetry
  - Beachwood grey
- Wood Flooring
  - Matching cabinetry selection
- Interior upholstery
  - Grey

#### *Forward Cabin*

- Carbon monoxide detector
- Lighting, overhead LED

- Outlet with USB, 120V
- Storage, wall cupboards
- Floor, carpet
- Berth, polyurethane high resilience foam mattress and bed covers
- Lighting, overhead LED
- Outlets, 120V (adjacent to bed)
- A/C Vent

#### *Aft Cabin*

- Carbon monoxide detector
- Ambient LED lights
- Floor, carpet
- Lighting, accent LED
- Lighting, overhead LED
- Outlets, 120V
- Storage, port and starboard

#### *Head*

- Door access to head with mirror
- Bathroom accessories – toothbrush holder, towel hooks, soap dispenser, toilet paper holder
- Cabinets, mirrored
- Corian countertop with bowl and chrome faucet
- Extractor fan
- Flooring, molded non-slip
- Lighting, overhead LED
- Outlet, 120V GFI Protected

### SYSTEMS

#### *Power & Drive Systems*

- Mercury Verado 3x 600 HP outboard engines
  - Stainless Steel Propellers
- Electro-hydraulic steering system
- Contra-rotating props
- Trim tabs

#### *Bilge*

- Bilge pumps, automatic electric (2) – forward and aft
- Bilge pumps, high water alarm
- Common drain system

#### *Air Conditioning*

- Air Conditioning with reverse cycle heating, Dometic MarineAir (56,000) BTU with dual control for interior and helm
- DC Electrical System (12V)
  - Batteries
  - Battery charger
  - Circuit Breakers
  - DC Main Switchboard
- AC Electrical System (120V)
  - Shore power, single 120V/50A
  - AC main switchboard
  - Generator, 12kW with sound shield

#### *Fuel System*

- Fuel tank, vented
- Fuel filters, 3 engines
- Fuel lines
- Fuel inlet
- Fuel stop valve
- Diesel Fuel tank, vented
- Diesel Fuel filter, 1 generator
- Diesel Fuel lines
- Diesel Fuel inlet
- Diesel Fuel stop valve

#### *Fresh Water System*

- Water tank stainless steel, vented
- Water inlet, stainless steel
- Water pump, automatic with filter
- Dockside/shore water connection
- Level indicator

#### *Waste Water System*

- Black Water Waste System
  - Waste tank, stainless steel with odor filter, water level sensor, vented
  - Waste pump, electric
  - Level indicator and pump switch
  - Dockside pumpout fitting – stainless steel
  - Overboard waste discharge fitting

### OTHER ITEMS

- Owner's manual and engine manual

# GTO

Layouts

## FACTORY OPTIONS

### Comfort Pack

- Cablemaster
- Cover for foredeck seating
- Cover for aft seating
- Raymarine Chartplotter/FF, 1x Axiom 16 xl RV-US
  - CP370 Transducer
  - Radar, Quantum Q24C 18"
- Additional Raymarine Chartplotter, 1x Axiom 16 xl [each, max 3 x 16"]
- Raymarine VHF RAY91 AIS and VHF Antenna
- Sunshade awning in cockpit

### Luxury Pack

- Refrigerator in galley portside lower deck
- Microwave
- Upgraded Fusion sound system with 2 amplifiers, 8 speakers, 1 subwoofer/stereo remote
- LED underwater lights 3/4 aft and 4 side, blue/white (7/8 pcs)
- TV LED 40" in front cabin
- TV LED 32" in aft cabin
- White and blue LED lights (cockpit, gate passage, lounge area)
- Chain counter display

### Individual Options

- Seakeeper 4.5
- Raymarine Cyclone 3ft open array radar
- Ice maker in cockpit
- Upgrade to 19" Raymarine screens
- Electric roof in salon with tinted glass
- Electric upper door for side passage with tinted glass
- Electric openable side windows on both sides
- Stainless steel anchor and chain
- Second grill or cooktop in cockpit
- Antifouling paint

### Colors and Materials

- Cabinetry
  - Matte Walnut with matching floor
  - or
  - Matte Eucalyptus with matching floor

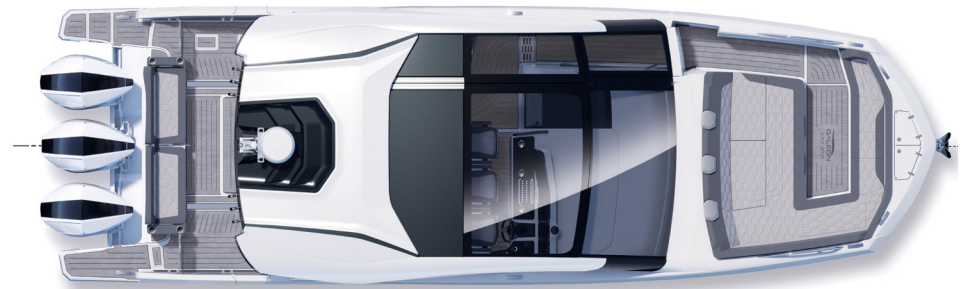

MAIN DECK

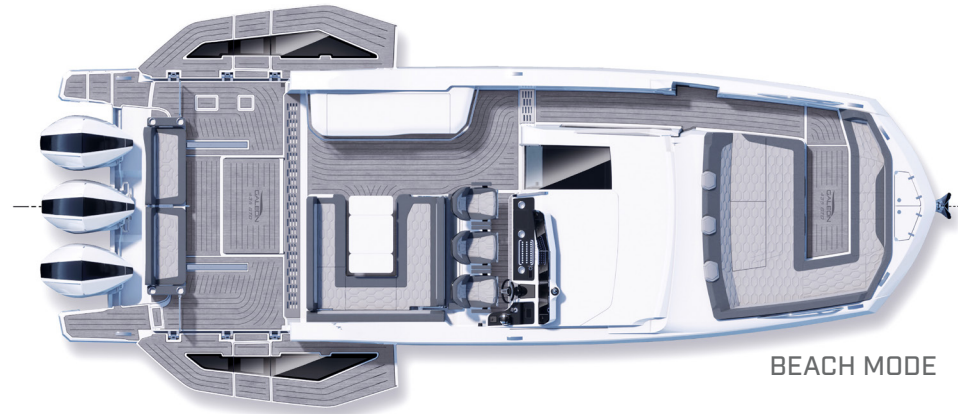

BEACH MODE

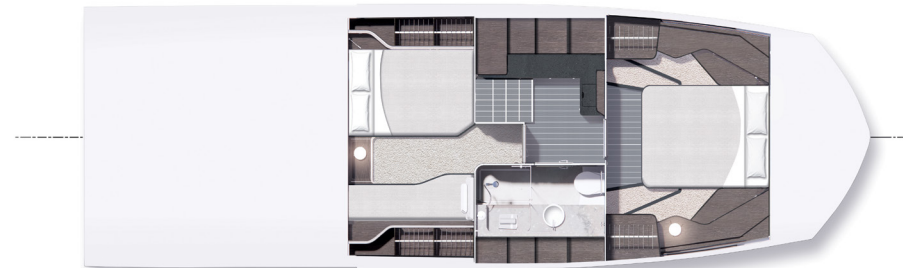

BELOW DECK

*\*The listed performance data is an estimate only based on vessel testing on fresh water with 6 people, full fuel and water and a clean hull bottom. The performance will change based on boating location, vessel loading and maintenance.*